

# Ready Rig Quick Connector

User Guide

使用说明

V1.0 2018.01

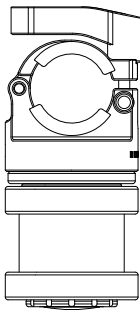

## Disclaimer and Warning

Congratulations on purchasing your new DJI OSMO™ product. The information in this document affects your safety and your legal rights and responsibilities. Read this entire document carefully to ensure proper configuration before use. Failure to read and follow instructions and warnings in this document may result in serious injury to yourself or others, damage to your DJI OSMO product, or damage to other objects in the vicinity. This document and all other collateral documents are subject to change at the sole discretion of DJI OSMO.

By using this product, you hereby signify that you have read this disclaimer and warning carefully and that you understand and agree to abide by the terms and conditions herein. You agree that you are solely responsible for your own conduct while using this product, and for any consequences thereof. You agree to use this product only for purposes that are proper and in accordance with all applicable laws, rules, and regulations, and all terms, precautions, practices, policies and guidelines DJI OSMO has made and may make available.

DJI OSMO accepts no liability for damage, injury or any legal responsibility incurred directly or indirectly from the use of this product. The user shall observe safe and lawful practices including, but not limited to, those set forth in this document.

Notwithstanding above, your statutory rights under applicable national legislation are not affected by this disclaimer.

OSMO is a trademark of SZ DJI OSMO TECHNOLOGY CO., LTD. (abbreviated as "DJI OSMO") and its affiliated companies. Names of products, brands, etc., appearing in this document are trademarks or registered trademarks of their respective owner companies. This product and document are copyrighted by DJI OSMO with all rights reserved. No part of this product or document shall be reproduced in any form without prior written consent of or authorization from DJI OSMO.

## Introduction

Use the Ready Rig Quick Connector to connect a Ready Rig and RONIN™ 2 Grip or other devices with a tube diameter of 25 mm or 30 mm.

## Usage

When used with devices using a 30 mm tube, such as Ronin 2, remove the two 25 mm adapters and store them properly before installation. When used with devices using a 25 mm tube, make sure to attach the adapters.

**In this example we connect to Ronin 2.**

1. Press and hold the button on the bottom to detach part B from part A. Then attach the hook and loop strap of the Ready Rig to the slot on part B.

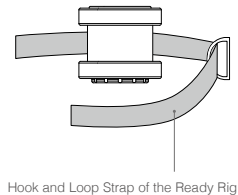
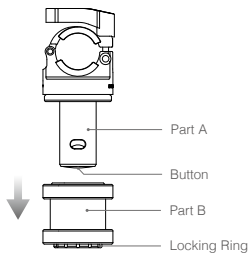

2. Remove the 25 mm adapters from part A.
3. Mount part A to the Ronin 2 grip, then tighten the knob.
4. Attach part B back to part A with its locking ring facing outward. Make sure to mind your fingers.

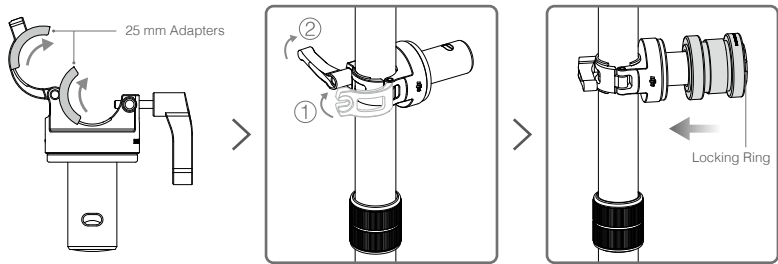

 When removing the Quick Connector, hold part B and then detach it from part A to prevent part B from shooting upward, which may cause injuries.

Please refer to <http://www.dji.com/service> for after-sales service for your product where applicable.

DJI OSMO shall mean SZ DJI OSMO TECHNOLOGY CO., LTD. and/or its affiliated companies where applicable.

## 免责声明和警告

感谢您购买大疆灵眸™ (DJI OSMO™) 产品。本文所提及的内容关系到您的安全以及合法权益与责任。使用本产品之前, 请仔细阅读本文以确保已对产品进行正确的设置。不遵循和不按照本文的说明与警告来操作可能会给您和周围的人带来伤害, 损坏本产品或其它周围的物品。本文档及本产品所有相关的文档最终解释权归大疆灵眸 (DJI OSMO) 所有。如有更新, 恕不另行通知。请访问 [www.dji.com](http://www.dji.com) 官方网站以获取最新的产品信息。

一旦使用本产品, 即视为您已经仔细阅读免责声明与警告, 理解、认可和接受本声明全部条款和内容。您承诺对使用本产品以及可能带来的后果负全部责任。您承诺仅出于正当目的使用本产品, 并且同意本条款以及大疆灵眸 (DJI OSMO) 制定的任何相关条例、政策和指引。

大疆灵眸 (DJI OSMO) 对于直接或间接使用本产品而造成的损坏、伤害以及任何法律责任不予负责。用户应遵循包括但不限于本文提及的所有安全指引。

即使存在上述规定, 消费者权益依然受当地法律法规所保障, 并不受本免责声明影响。

OSMO 是深圳市大疆灵眸科技有限公司及其关联公司的商标。本文出现的产品名称、品牌等, 均为其所属公司的商标或注册商标。

## 简介

便力背连接组件用于固定便力背与 RONIN™ 2 手持环或其他管径为 25 mm 或 30 mm 的载具。

## 使用

安装至 30 mm 管径的载具 (如 Ronin 2) 时, 请取下连接组件上的两个 25 mm 转接件并妥善保管。安装至 25 mm 管径的载具时, 需重新装回 25 mm 转接件再行使用。

以下使用方法以安装至 Ronin 2 为例。

1. 按住连接件底部的按钮, 将下方的连接件 B 完全分离, 然后将便力背魔术贴固定至连接件 B 的凹槽。

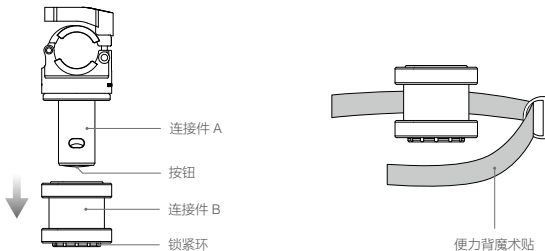

2. 移除连接件 A 上的 25 mm 转接件。
3. 将连接件 A 安装至 Ronin 2 手持环，然后拧紧旋钮。
4. 将连接件 B 装回至连接件 A 的下方，确保锁紧环朝向外侧。安装时小心夹手。

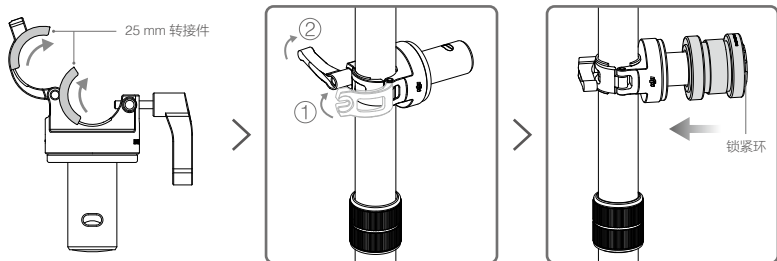

**!** 拆卸便力背连接组件时，务必握住连接件 B 然后再将其从连接件 A 上完全分离，否则连接件 B 可能弹起而造成人身伤害。

浏览 <http://www.dji.com/service> 以获取产品的售后信息。  
“DJI OSMO”表示深圳市大疆灵眸科技有限公司及其关联公司。



Copyright © 2018 DJI OSMO All Rights Reserved.  
YC.BZ.SS000218.02

Printed in China.